



## TRITON Covered Walkway

The inherent design flexibility of the TRITON polycarbonate roof canopy systems makes them ideally suited to the provision of covered walkways, where site users require protection from the elements when connecting between buildings. The canopy designs readily accommodate changes of level and direction, and can be tailored around irregular shaped buildings and paths to provide complete coverage of routes around your site.

All of our TRITON canopies are designed and manufactured in accordance with BS EN 1090 EXC 2 accreditation, offering outstanding durability from an all-steel frame with polyester powder coat finish and galvanised steel rainwater goods. The standard roof specification is the advanced multiwall polycarbonate providing a bright atmosphere without glare, with our proven aluminium glazing system ensuring a

reliable and easy to maintain roof cover for the long term. The 25-year structure and 15-year roof covering warranties provide long term peace of mind, with aftercare packages available for periodic inspection and cleaning.

Enclosing covered walkways with glass or polycarbonate sides increases the weather protection further, with the potential to address safeguarding issues at the same time.

Streetspace has extensive in-house expertise in civil engineering and external works, offering complete turn-key packages including foundation installation, surfacing and drainage and any associated mechanical and electric elements.

**No length limit**

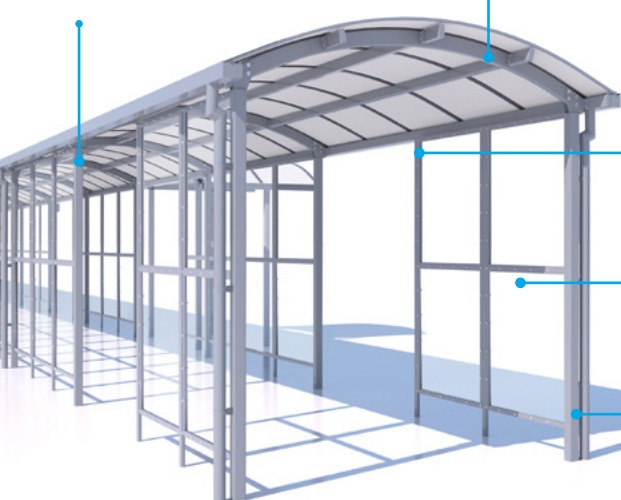

### Canopy Form

TRITON Covered Walkways can be constructed in three forms: symmetric, asymmetric or mono pitch with multiwall polycarbonate or toughened and laminated glass roofing panels

### Clear span widths of up to 6m

TRITON Covered Walkways can be constructed in any width between 1m and 6m

### Options

Available options include windbreak side panel sections, canopy lighting and timber post capping.

### Post Centres

Standard post centres are between 3.5m and 5.5m with variations within the structure possible to avoid doorways, access routes or underground services

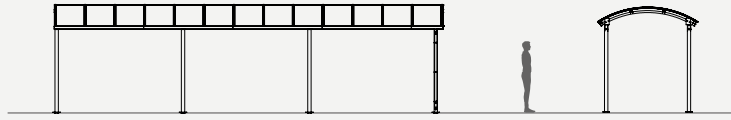

## Design Features



### Glazing & Rainwater Systems

Aluminium roof glazing system and galvanised powder coated steel rainwater systems for long term reliability.



### Roof Cladding Options

Select from multiwall polycarbonate or toughened and laminated glass.



### All Weather Protection

Enclosure options include solid or multiwall polycarbonate, planar glass and aluminium glazed curtain walling.



### Great Aesthetics

Single beam radius roof, eaves oversail, rafter and purlin connections and colour coordinated integral rainwater systems.



### Design Form Flexibility

TRITON covered walkways can be manufactured as radius symmetric, asymmetric or mono pitch design.



### Confidence in Accreditation

Streetspace design, manufacturing and construction processes are accredited to ISO9001, ISO14001 and BS EN 1090 CE EXC 2.

## Product Specification

TRITON Covered Walkways are available with a number of different forms and support options. Projects are surveyed and modelled prior to detailed design commencement, incorporating existing levels, service cover locations and adjacent door and window positions.

### Canopy Form

TRITON Covered Walkways can be constructed in three forms: symmetric, asymmetric or mono pitch. Asymmetric structures are particularly suitable for positioning against existing buildings.

### Canopy Support

As well as the standard freestanding design, TRITON Covered Walkways are available as either cantilevered structures or wall mounted, providing the wall meets the appropriate structural requirements.

### Canopy Dimensions

TRITON covered walkways can be constructed in any width between 1m and 6m, there is no limit on the length. Standard post centres are between 3.5m and 5.5m with variations within the structural design achievable to avoid doorways, access routes or underground services.

## Frame Finishes

Highly durable polyester powder coatings are applied as the standard finish on steel frame TRITON canopies with colours selected from a basic range or from the RAL colour selector. Steelwork is cold grit-blasted to SA2.5, with a zinc coating and anti-corrosive primer, followed by the high gloss polyester colour powder coat finish. Alternatively, hot-dip galvanised coatings can be specified for the harshest environments where a decorative finish is not required. The colours and finishes depicted on this website are representations and should not be taken as accurate.



Hot-Dip Galvanised

Colour Polyester Powdercoat

## Canopy Options

Adding options to your TRITON canopy allows even greater flexibility for extending the use of the covered space.

### Lighting

High-efficiency LED lighting solutions are available to enable safe use of your covered walkway outside of daylight hours.

### Timber Post Capping

Adding timber post cappings can help soften the appearance of a steel frame structure.

### Windbreak Panels

The addition of windbreak side panel sections for canopy sections most exposed to inclement weather is a cost effective means of increasing value from the facility.

